

LODESTAR[®] BGV-C1[®]

CAPACITIES

250 to 1300 KG.

LIFT

18, 20 & 24 meters
standard

SPEEDS

2 to 30 meters/minute

VOLTAGES

400VAC 3phase 50Hz only
No single phase versions

The Lodestar BGV-C1 Series meets the BGV-C1 German regulation for entertainment rigging. Available with fixed or variable speed, the Lodestar BGV-C1 can be adapted to reach a System Integrity Level 3 (SIL3)*

KEY FEATURES

ELECTRO-MECHANICAL PASSIVE DOUBLE BRAKES

5 POCKET LIFT WHEEL

For quiet & smooth operation.

68 dB OPERATIONAL NOISE

A result of the Double Brake System

GEARING

Precision machined gears heat treated for strength and durability.

INTERNAL CHAIN GUIDE

PVC black coated for quieter operation

LOW VOLTAGE CONTROL

110 Volt for long cable runs without voltage drop. 24 & 48 Volt optional.

DUTY CYCLE

H-4 duty rated for heavy duty application. 2M FEM class. 50% Duty Cycle or 300 on/off per hour

10:1 MECHANICAL DESIGN FACTOR

14:1 LOAD CHAIN DESIGN FACTOR

UNDERLOAD PROTECTION

with load cell installed

MODULAR MULTI-PIN CONNECTOR

with multi-wire shielded cable

4 POSITION LIMIT SWITCH

with active spring micro-switch

BUILT-IN PLC

For safety function monitoring, Brake and Limit Switch integrity, Load Cell reading, Overload and Underload settings

STANDARD FEATURES

OVERLOAD PROTECTION

Rated operational range between 125 and 150/160%. Clutch is outside the load path when disconnected from power.

DURABLE & LIGHTWEIGHT HOUSING

Cast aluminum. Black powder coated finish for low visibility.

METRIC RATED

LOAD CHAIN

Designed and manufactured by Columbus McKinnon. Zinc plated to protect against corrosion. Black phosphate finish optional.

THE INDUSTRY'S BEST LIFETIME WARRANTY

MEETS OR EXCEEDS WORLD STANDARDS

Meets German Regulation BGV-C1

OPTIONAL FEATURES

CHAIN BAG

Easy-to-Mount Cloth Type Bags

CHAIN STOP

Mounted on load chain to prevent overtravel.

LOAD CELL

Built in on the suspension hook

* SIL3 requires a BGV-C1 SIL3 certified controller not included.



THE POWER TO PERFORM

SPECIFICATIONS BGV-C1

	Rate Load	Standard Lifting Speed at 50Hz	Operating Voltage	FEM Class	FEM Duty Factor	Chain Weight per meter lift-EWL	Load Chain EN 818-7	Power Consumption -Full Load	Reeves Falls of Chain	Motor HP	Protection Class	Noise Level
Model F	250 Kg	4 m/min	400-3-50	2M	50%	0,89 Kg	6,3 x 18,9	1,2 Amp	1	0,5 HP	IP 54	68 dB
Model J	250 Kg	4 m/min	400-3-50	2M	50%	0,89 Kg	6,3 x 18,9	1,2 Amp	1	0,5 HP	IP 54	68 dB
Model JJ	500 Kg	16 m/min	400-3-50	2M	50%	1,42 Kg	7,9 x 21,7	3,6 Amp	1	2 HP	IP 54	68 dB
Model L	500 Kg	4 m/min	400-3-50	2M	50%	1,42 Kg	7,9 x 21,7	2,3 Amp	1	1 HP	IP 54	68 dB
Model LL	650 Kg	8 m/min	400-3-50	2M	50%	1,42 Kg	7,9 x 21,7	3,6 Amp	1	2 HP	IP 54	68 dB
Model RR	1300 Kg	4 m/min	400-3-50	2M	50%	2,84 Kg	7,9 x 21,7	3,6 Amp	2	2 HP	IP 54	68 dB
Varistar	500 Kg	30 m/min	400-3-50	2M	50%	1,42 Kg	7,9 x 21,7	6 Amp	1	3 HP	IP 54	68 dB

DIMENSIONS

DRAWING LEGEND	BGV-C1 SERIES		
	F	L, LL	JJ, RR VARISTAR
B Body High	15,4 cm	19,4 cm	19,4 cm
C Hook Thickness: Side	1,7 cm	2,2 cm	2,9 cm
D Housing: Brake Side	29,7 cm	25,3 cm	25,3 cm
F Housing: Motor Side	22,5 cm	32,9 cm	32,9 cm
H Hook Thickness: High	2,5 cm	3,0 cm	3,8 cm
I Housing: Side Left	11,3 cm	17,6 cm	14,2 cm
J Housing: Side Right	10,7 cm	14,5 cm	17,9 cm
M Hook Opening	2,5 cm	2,8 cm	3,3 cm
P Body High with Suspension	16,8 cm	20,8 cm	20,8 cm

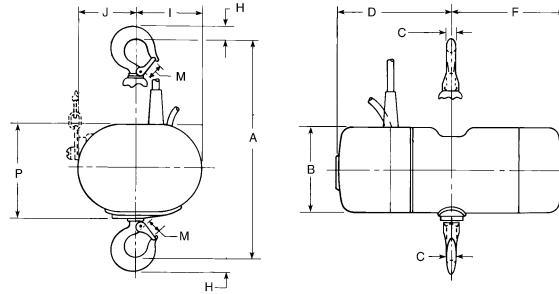

REGULATION & STANDARDS

The Lodestar BGV-C1 meets or exceeds the most stringent standards for lifting equipment around the world, including the following: ASME B30.16; ASME HST-1; EC Machine Directive 2006/42 EC; Low Voltage Directive 73/23/EEC; EC EMC Directive 89/336/EEC; FEM 9.511; FEM 9.671; FEM 9.811; FEM 9.683; FEM 9.941; FEM 9.755; EN 12100-1 :2003; EN 12100-2 :2003; EN 60204-1 :2006; EN 349 :1993; EN 60204-32 :1998; EN 55011 :2009; EN 55014 :2006; DIN 568-3; EN ISO 13857 :2008 ; EN 14492-2 :2007; DIN 56950; BS 7905-1; BS 7906-1; CEN 15902 (ex CEN CWA 25); VPLT SR2.0; BGV-C1; EN 818-7 :2008-07

In addition to the popular Lodestar, numerous rigging accessories are available as part of the CM-ET line. Theatrical shackles, lever hoists, winches, beam clamps, and wire rope clips provide riggers with numerous options, depending on the venue. Most product categories feature a wide range of capacities, allowing the user to choose the exact product for the job.



COLUMBUS MCKINNON CORPORATION
ENTERTAINMENT PRODUCTS DIVISION

140 John James Audubon Parkway, Amherst, New York 14228

USA 800.888.0985 | +1 716.689.5400 | Fax +1 716.689.5619 | www.cm-et.com